

# 6. CONSTRUCTION / PARTS LIST

## 1) Construction

AW20-B

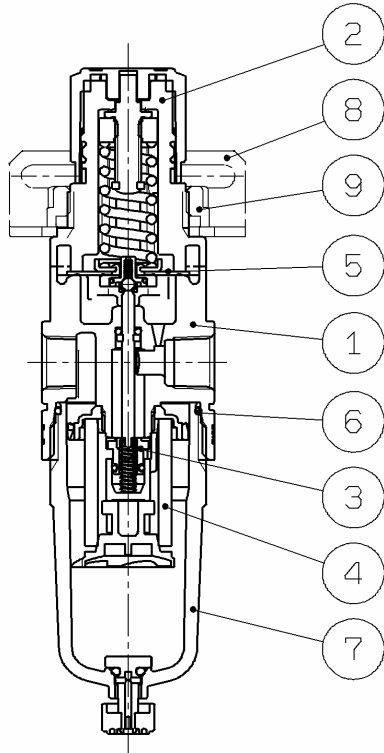

AW60-B

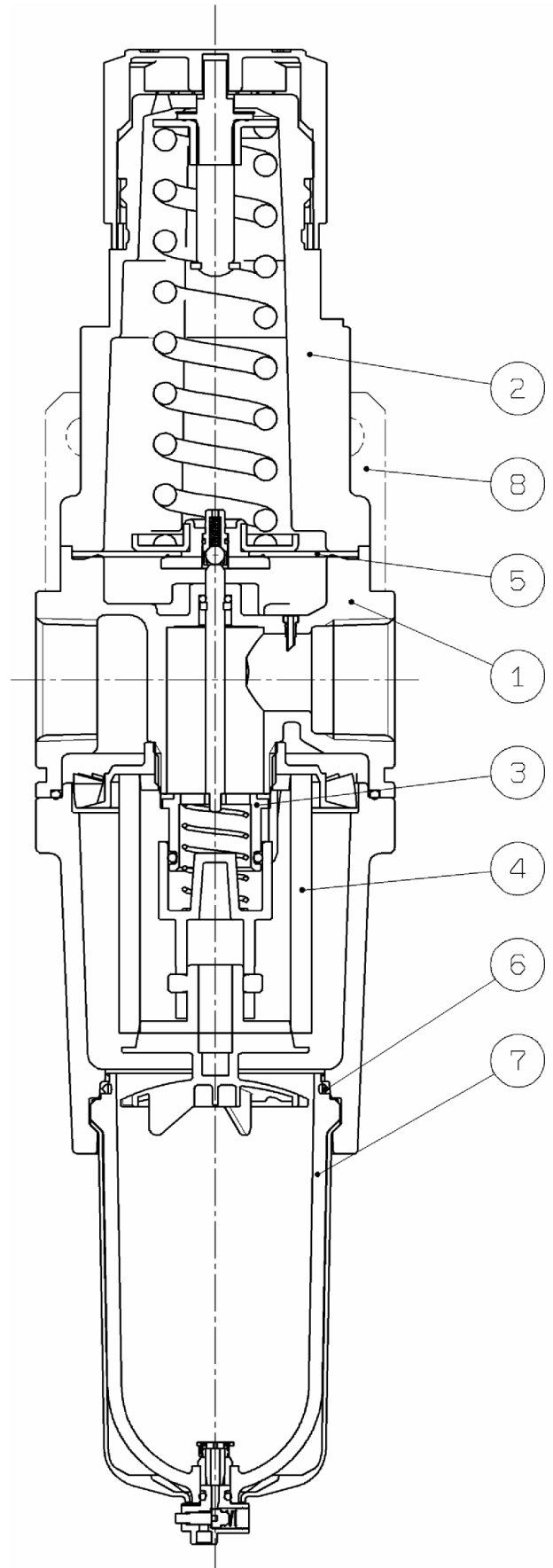

AW30-B / AW40-B

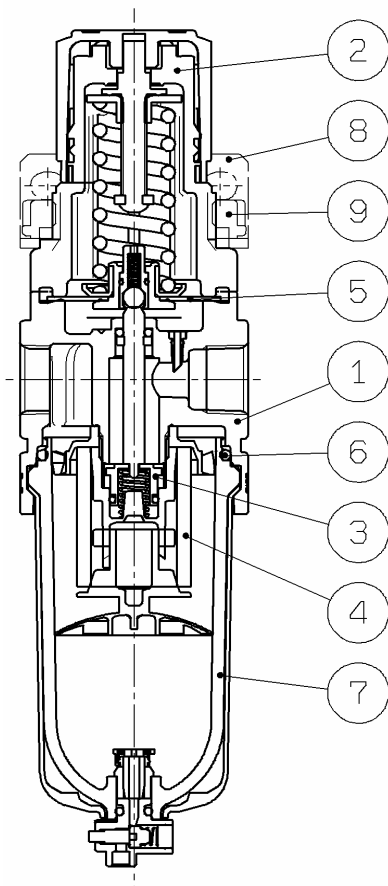

2) PARTS LIST

**Component Parts**

No.	Description	Applicable model	Material	Note
①	Body	AW20 to 60-B	Aluminium die cast	Urban white
②	Bonnet	AW20 to 40-B	Polyacetal	Urban white
		AW60-B	Aluminium die cast	

**Option / Replacement Parts**

No.	Description	Thread		Option Specification	Material	Part No.			
		Type	Symbol			AW20-B	AW30-B	AW40(-06)-B	AW60-B
③	Valve assembly	—	—	—	Brass+HNBR	AW20P-340AS	AW30P-340AS	AW40P-340AS	AW60P-090AS
④	Element	—	—	—	Polyolefin	AF20P-060S	AF30P-060S	AF40P-060S	AW60P-060S
⑤	Diaphragm assembly	—	—	—	Weatherproof NBR	AR20P-150AS	AR30P-150AS	AR40P-150AS	AR50P-150AS
		—	N	Non-relieving type	Weatherproof NBR	AR20P-150AS-N	AR30P-150AS-N	AR40P-150AS-N	AR50P-150AS-N
⑥	Bowl seal	—	—	—	NBR	C2SFP-260S	C32FP-260S	C42FP-260S	
⑦	Bowl assembly	Refer to "7. SPECIFICATIONS OF BOWL ASSEMBLY" (P12 to P19).							
	Auto drain (N.C.)								
	Auto drain (N.O.)								
⑧	Note1) Bracket assembly	—	—	—	Steel plate / Polyacetal	AW23P-270AS	AR33P-270AS	AR43P-270AS	Note2) AW62P-270AS
⑨	Set nut	—	—	—	Polyacetal	AR23P-260S	AR33P-260S	AR43P-260S	—
⑩	Note3) Square embedded pressure gauge	Rc	—	—	—	GC3-10AS			
			1	0.2MPa setting	—	GC3-4AS			
		NPT	—	—	—	GC3-10AS			
			1	0.2MPa setting	—	GC3-4AS			
			Z	Imperial unit: MPa, psi	—	GC3-P10AS-X30			
		G	1Z	0.2MPa setting Imperial unit: MPa, psi	—	GC3-P4AS-X30			
			—	—	—	GC3-10AS			
1	0.2MPa setting	—	GC3-4AS						
⑪	Pressure gauge cover	—	—	—	—	GC3P-010AS			
⑫	Round type pressure gauge	Rc	—	—	—	G36-10-01		G46-10-01	
			1	0.2MPa setting	—	G36-4-01		G46-4-01	
		NPT	—	—	—	G36-10-N01		G46-10-N01	
			1	0.2MPa setting	—	G36-4-N01		G46-4-N01	
			Z	Imperial unit: MPa, psi	—	G36-P10-N01-X30		G46-P10-N01-X30	
		G	1Z	0.2MPa setting Imperial unit: MPa, psi	—	G36-P4-N01-X30		G46-P4-N01-X30	
			—	—	—	G36-10-01		G46-10-01	
	1	0.2MPa setting	—	G36-4-01		G46-4-01			
	Round type pressure gauge (with colour zone)	Rc	—	—	—	G36-10-01-L		G46-10-01-L	
			1	0.2MPa setting	—	G36-4-01-L		G46-4-01-L	
		NPT	—	—	—	G36-10-N01-L		G46-10-N01-L	
			1	0.2MPa setting	—	G36-4-N01-L		G46-4-N01-L	
			Z	Imperial unit: MPa, psi	—	G36-10-01-L		G46-10-01-L	
		G	1	0.2MPa setting	—	G36-4-01-L		G46-4-01-L	
—			—	—	G36-10-01-L		G46-10-01-L		
⑬	Pressure gauge adaptor assembly	Rc	—	—	Aluminium die cast	ARP20P-310AS-01			
		G	—	—		ARP20P-310AS-N01			
		NPT	—	—		ARP20P-310AS-F01			
⑭	Plug assembly	Rc	—	—	—	ARP20P-320AS-01			
		G	—	—		ARP20P-320AS-N01			
		NPT	—	—		ARP20P-320AS-F01			
⑮	Plug	Rc	—	—	PBT resin	AR20P-370AS-01			
		G	—	—		AR20P-370AS-N01			
		NPT	—	—		AR20P-370AS-01			
⑯	Blanking plate assembly	—	—	—	—	AR20P-250AS			

Note1) Bracket and Set nut assembly.

Note2) Bracket with mounting screws.(2pcs)

Note3) With O-ring (1 piece) and Mounting screws (2 pcs).

Note4) The number in the table is corresponding to the number in structural drawing (P10) and "7. SPECIFICATIONS OF BOWL ASSEMBLY" (P12 to P19), "9. DISASSEMBLY DRAWING" (P24 to P28).